



N 50' Plug Door Box Car

Announced 7.26.19
Orders Due: 8.30.19

ETA: July 2020

Frisco

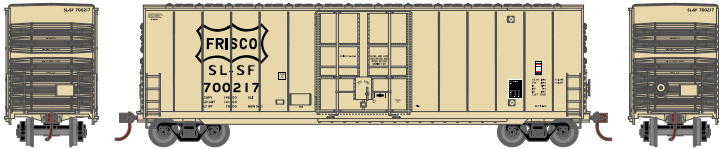

- ATH1419 N 50' Smooth High Cube Plug Door Box, SLSF #700217
- ATH1420 N 50' Smooth High Cube Plug Door Box, SLSF #700258
- ATH1421 N 50' Smooth High Cube Plug Door Box, SLSF #700291

Burlington Northern



- ATH1416 N 50' Smooth High Cube Plug Door Box, BN Late #732728
- ATH1417 N 50' Smooth High Cube Plug Door Box, BN Late #732738
- ATH1418 N 50' Smooth High Cube Plug Door Box, BN Late #732744

Burlington Northern Santa Fe



- ATH1413 N 50' Smooth HC Plug Door Box, BNSF Round #712702
- ATH1414 N 50' Smooth HC Plug Door Box, BNSF Round #712779
- ATH1415 N 50' Smooth HC Plug Door Box, BNSF Round #712785

Iowa Northern Railway



- ATH1422 N 50' Smooth High Cube Plug Door Box, IANR #1021
- ATH1423 N 50' Smooth High Cube Plug Door Box, IANR #1033
- ATH1462 N 50' Smooth High Cube Plug Door Box, IANR #1040

Santa Fe



- ATH1463 N 50' Smooth High Cube Plug Door Box, ATSF #151603
- ATH1464 N 50' Smooth High Cube Plug Door Box, ATSF #151622
- ATH1465 N 50' Smooth High Cube Plug Door Box, ATSF #151654

Cotton Belt*



- ATH1466 N 50' Smooth High Cube Plug Door Box, SSW #24344
- ATH1467 N 50' Smooth High Cube Plug Door Box, SSW #24268
- ATH1468 N 50' Smooth High Cube Plug Door Box, SSW #24316

Golden West



- ATH1469 N 50' Smooth High Cube Plug Door Box, VCY #179031
- ATH1470 N 50' Smooth High Cube Plug Door Box, VCY #179086
- ATH1471 N 50' Smooth High Cube Plug Door Box, VCY #179111

All Road Names

PROTOTYPE AND BACKGROUND INFO:

Railroad boxcars are perhaps not only the best-recognized pieces of equipment ever put into service but also one of the most identifiable symbols of the industry itself. During the early years of the industry, freight was hauled on simple flatcars or early gondolas. In Upstate New York was the burgeoning Mohawk & Hudson Railroad, the first chartered system in the United States which later became part of the New York Central, came up with the novel idea of covering its gondolas in 1833 since the railroad dealt with snow throughout much of the winter.

The Roundhouse 50' High Cube, Plug Door boxcar is based on a common type of boxcar that began appearing in large numbers in the late 1970s. Such cars required greater overhead clearance to operate safely, but boasted greater cubic capacity that comparable standard-height cars. These cars commonly haul canned goods, finished rolls of paper, appliances, furniture, and lumber.

MODEL FEATURES:

- Former MDC tooling
- Brand new paint schemes
- Fully-assembled and ready to run
- Highly-detailed, injection-molded body
- Separate brake wheel
- Painted and printed for realistic decoration
- Machined metal wheels
- Weighted for trouble free operation
- Body-mounted McHenry operating scale knuckle couplers
- Clear plastic jewel box for convenient storage
- Operates on Code 55 and 80 rail
- Minimum radius: 9 3/4"

PRIMED FOR GRIME MODELS FEATURE:

- Duplicated look and feel of "In Service" equipment; "Tattered and Torn" just like the real thing
- Faded base colors matched to the prototype
- Patches applied and shaped per road number matching each corresponding side to the prototype
- Perfect starting point for adding grime and rust



#Ready2Rust

\$24.98 SRP



Visit Your Local Retailer | Visit www.athearn.com | Call 1.800.338.4639

* Union Pacific Licensed Product