



50ft FMC 5327 Plug Door Box Car

HO

ALL-NEW TOOLING WITH ACCURATE DIMENSIONS!

Bay Line

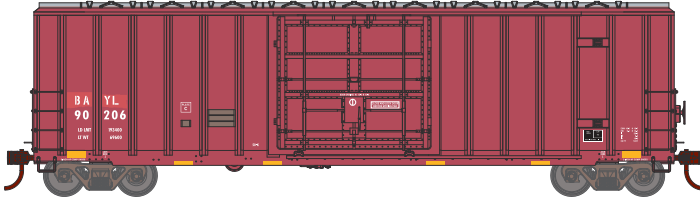

Era: 2006+



ATH18673	BAYL #90206
ATH18674	BAYL #90207
ATH18675	BAYL #90255

Canadian Pacific

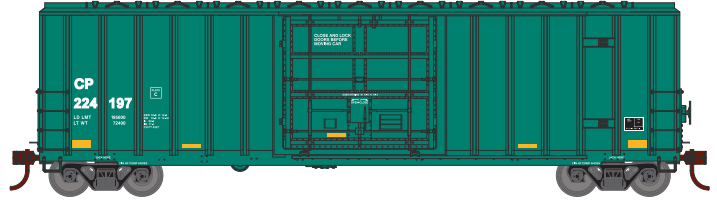

Era: 2021+

ATH18676	CP #224197
ATH18677	CP #224220
ATH18678	CP #224234

Minnesota Dakota & Western

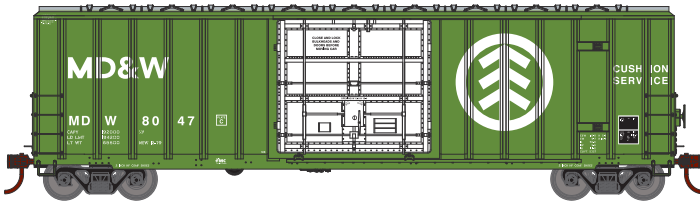

Era: 1979+

ATH18679	MDW #8047
ATH18680	MDW #8056
ATH18681	MDW #8082

New Orleans Public Belt

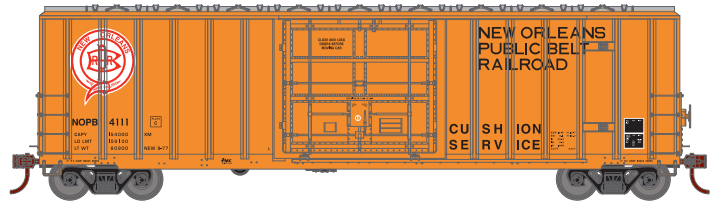

Era: 1977+

ATH18682	NOPB #4111
ATH18683	NOPB #4125
ATH18684	NOPB #4138

Quebec-Gatineau Railway Inc

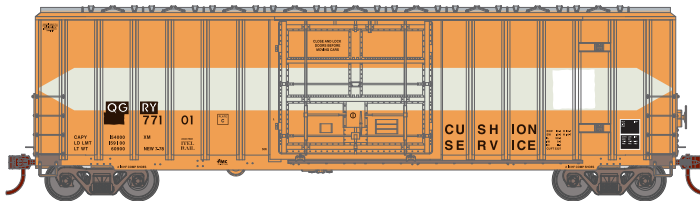

Era: 1990's+



ATH18685	QGRY #77101
ATH18686	QGRY #77115
ATH18687	QGRY #77124

MODEL FEATURES:

- Photo-etched cross-over platform
- Separately applied grab irons, end ladders and brake wheel
- 33" machined metal wheels with RP25 contours
- Weighted for optimum performance
- Body-mounted McHenry® operating scale knuckle couplers
- Highly-detailed, injection-molded body
- Painted and printed for realistic decoration
- All models are representative of prototypical paint schemes
- Minimum radius: 18"

PROTOTYPE AND BACKGROUND INFO:

It was the mid-1970s, and the incentive per diem box car boom was just beginning. New, brightly painted box cars seemed to appear overnight. Many were lettered for various short lines. FMC (Food Machinery Corporation) was a significant builder of many of these cars. The 50' outside post, non-terminating end box car, became the foundation for new per diem cars built in the 1970s. The 50' FMC cars also varied in door configuration and style to better suit each customer. These models can still be seen today in the modern railroading scene.

PRIMED FOR GRIME MODELS FEATURE

- Duplicated look and feel of "In Service" equipment
- Faded base colors matched to the prototype
- Perfect starting point for adding grime and rust

\$39.99 INDIVIDUAL | \$44.99 PRIME FOR GRIME

Orders Due: 11.25.22

ETA: December 2023



VISIT Your Local Retailer
CLICK Athearn.com
CALL 1.800.338.4639